



Instructions

FORD RANGER TRUCK BED MOLLE PANELS

Thank you for purchasing your Bed MOLLE Panels from AAL! We greatly appreciate your trust in our company. We take that purchase and your commitment to us very seriously. If you have any questions along the way, please don't hesitate to give us a call at 385.202.4188.

****Please read these instructions thoroughly before starting this project.****

****These instructions will cover the installation of the front, driver, and passenger side truck bed MOLLE Panels. If you only purchased one or two of the three, scroll to the instructions for your specific panel(s)****

Tools/Components Required:

There is more than one tool for every job, but below is the list of tools we use for this installation.

Tools listed are for assembly only, as disassembly tools will vary.

- 4mm Hex Key Allen Wrench
(for M6 hex key bolts)
- 5mm Hex Key Allen Wrench
(for M8 hex key bolts)
- 10mm Hex Key Allen Wrench

What's Included

Front Bed MOLLE Parts:

Driver Front Panel	1	Driver Brace	1
Passenger Front Panel	1	Passenger Brace	1
Front Connector	1	Lower Connector Brace	

Driver Side Bed MOLLE Parts:

Rear Driver Side Panel	1	Upper Connector Brace	1
Front Driver Side Panel	1		
Middle Bracket	1		

Passenger Side Bed MOLLE Parts:

Rear Passenger Side Panel	1	Upper Connector Brace	1
Front Passenger Side Panel	1		
Middle Bracket	1		

Front Bed MOLLE Hardware:

M6x14mm Button Head Bolts	12
M8x20mm Button Head Flange Bolts	2
M6 Nylon Insert Nuts	12

Side Bed MOLLE Hardware (Per Side!):

M6x14mm Button Head Bolts	10
M6x14mm Button Head Flange Bolts	4
M8x20mm Button Head Flange Bolts	2
M6 Nylon Insert Nuts	10

Part Overview and Prep

First lets review images of all the necessary parts and hardware to ensure we have everything we need for the installation process



Front Bed MOLLE Parts:

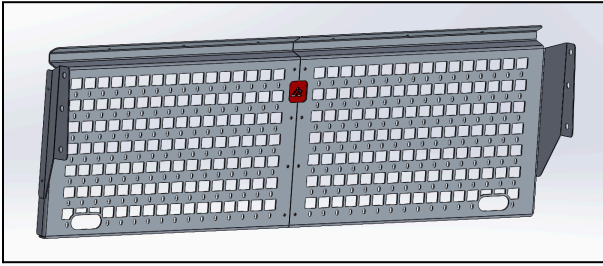

Driver Front Panel (1):

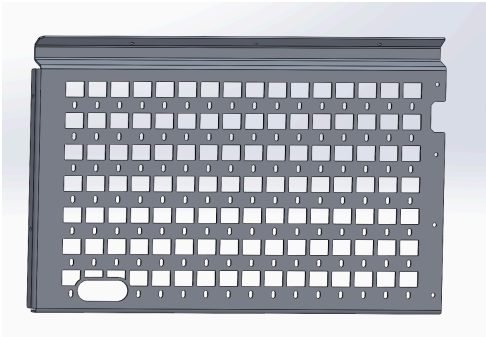

Passenger Front Panel (1):

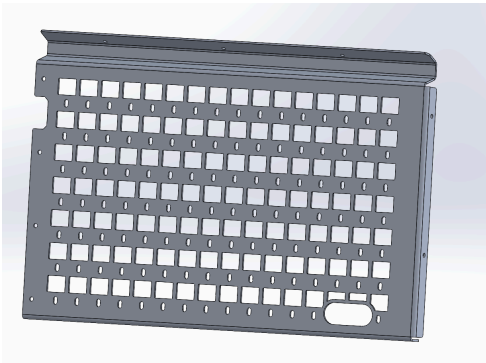

Front Connector (1):



Lower Connector Brace (1):



Passenger Bottom Brace (1):

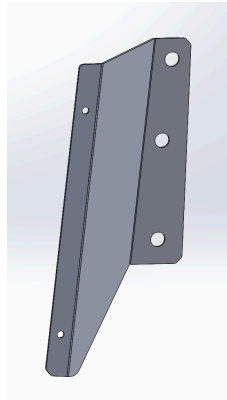

Driver Bottom Brace (1):

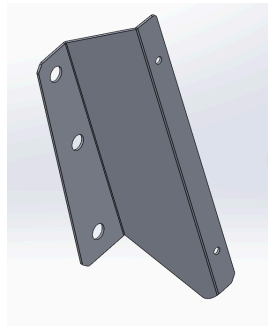

Passenger Side Bed MOLLE Parts:

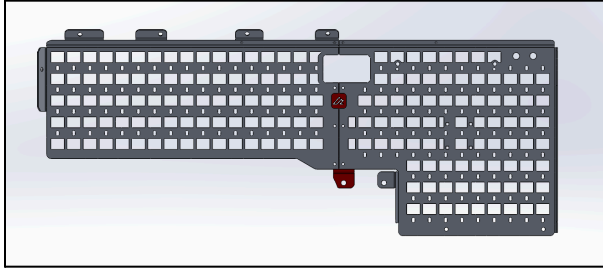

Rear Passenger Side Panel (1):

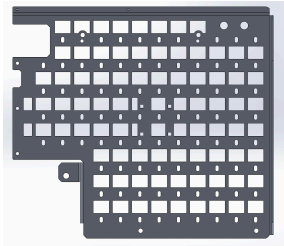

Front Passenger Side Panel (1):

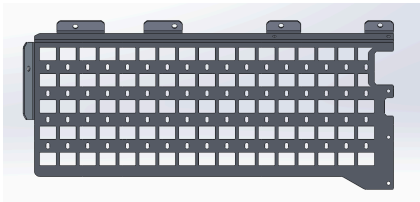

Middle Connector (1):

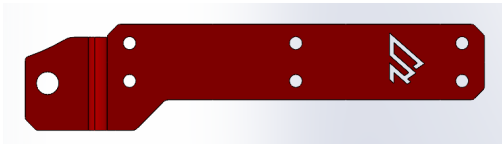

Upper Connector Brace (1):



Driver Side Bed MOLLE Parts:

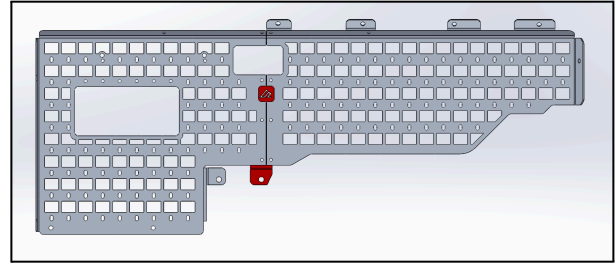

Rear Driver Side Panel Power Configuration (1):

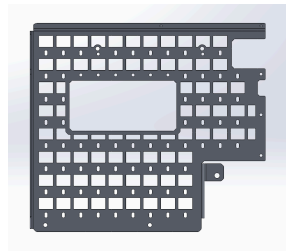

Rear Driver Side Panel Default configuration (1):

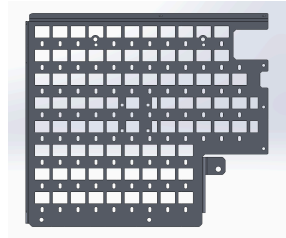

Front Driver Side Panel (1):

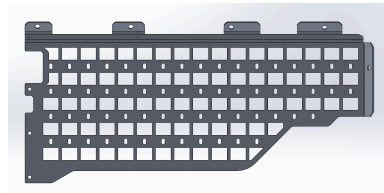

Middle Connector (1):



Upper Connector Brace (1):



Front Bed Panel Hardware:

M6x14mm Button Head Bolts 14



M8x16mm Button Head Flange Bolts 2



M8 Washer 2



M6 Nylon Insert Nuts 14



Side Panel Hardware (per side!):

M6x14mm Button Head Bolts 10



M6 Nylon Insert Nuts 10



M6x14mm Button Head Flange Bolts 4



M8x16mm Button Head Flange Bolts 2



M8 Washer 2



M6 nutcerts 4



Prep

To prepare for installation, do the following:

- 1) Unscrew/clear the three holes on the front of the bed on the passenger and driver side

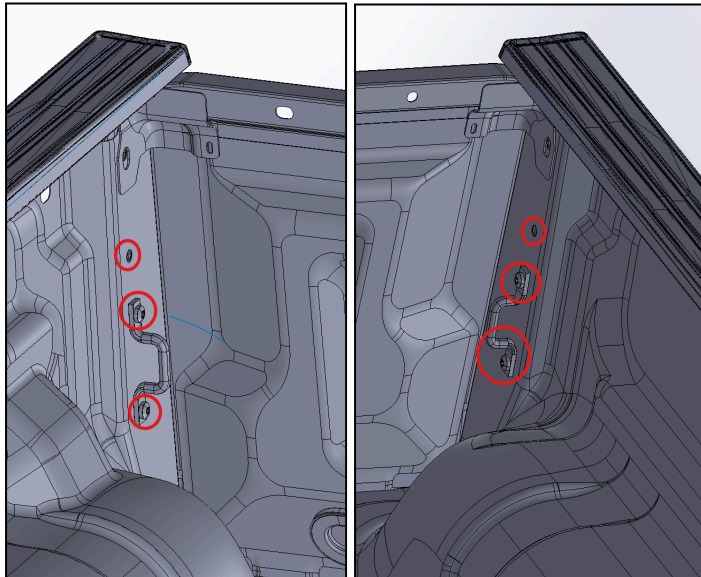

- 2) Unscrew/clear the two holes towards the rear of the bed on the driver and passenger side

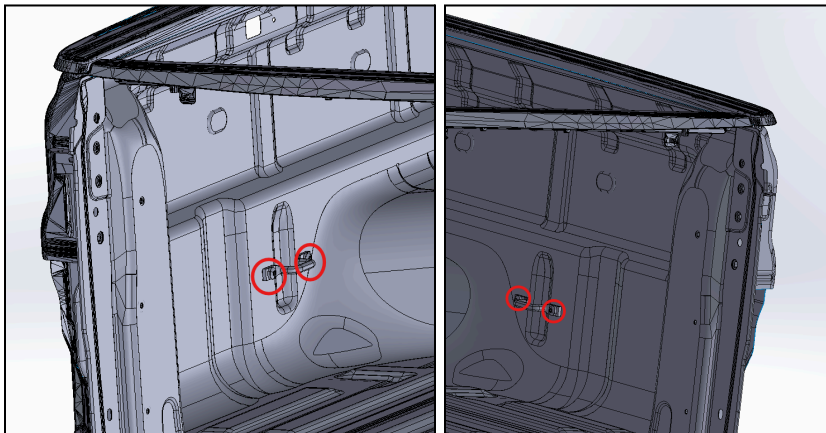

- 3) Unscrew/clear the two holes towards on the rear face of the bed on the driver and passenger side

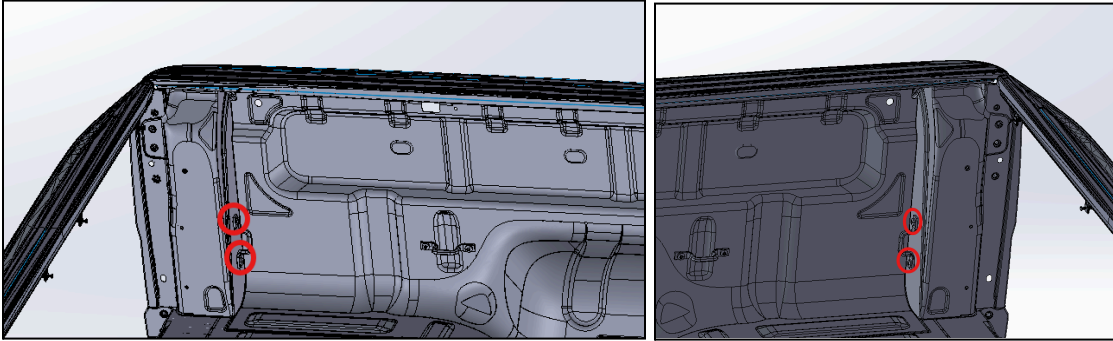

FRONT PANEL ASSEMBLY

If you didn't purchase the Front Bed MOLLE Panels, skip ahead to the Driver and Passenger Side Assemblies

Step 1 - Connect the Front MOLLE Panels

Flip over the **Front Passenger** and **Front Driver Panels** and align the **Front Connector** Bracket with the six holes shown below on the back side.

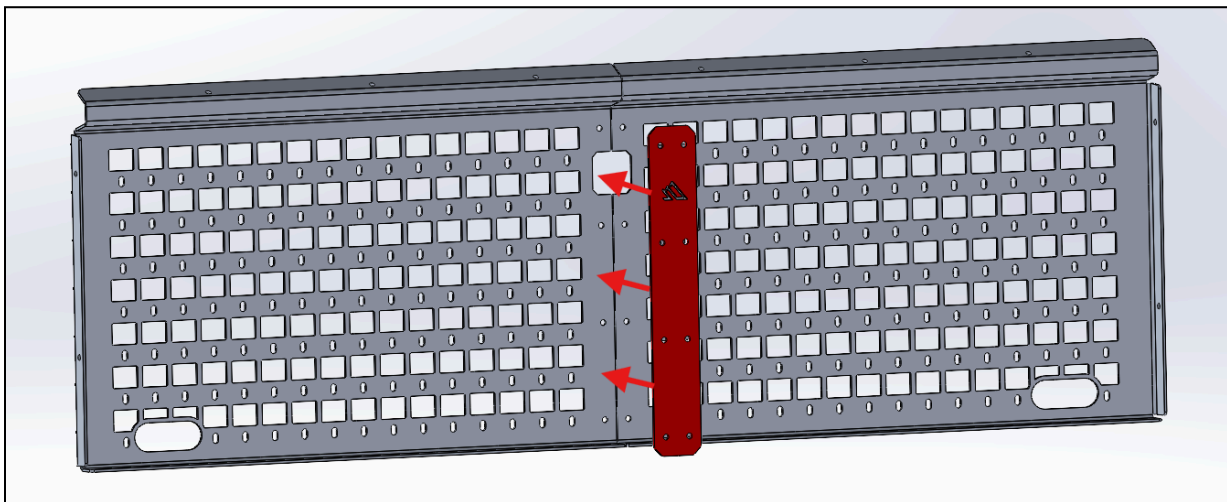

Once aligned, bolt the connector to the two panels through the Front of the panels using **(8) M6x14mm Button Head Bolts** and **(8) M6 Locknuts**

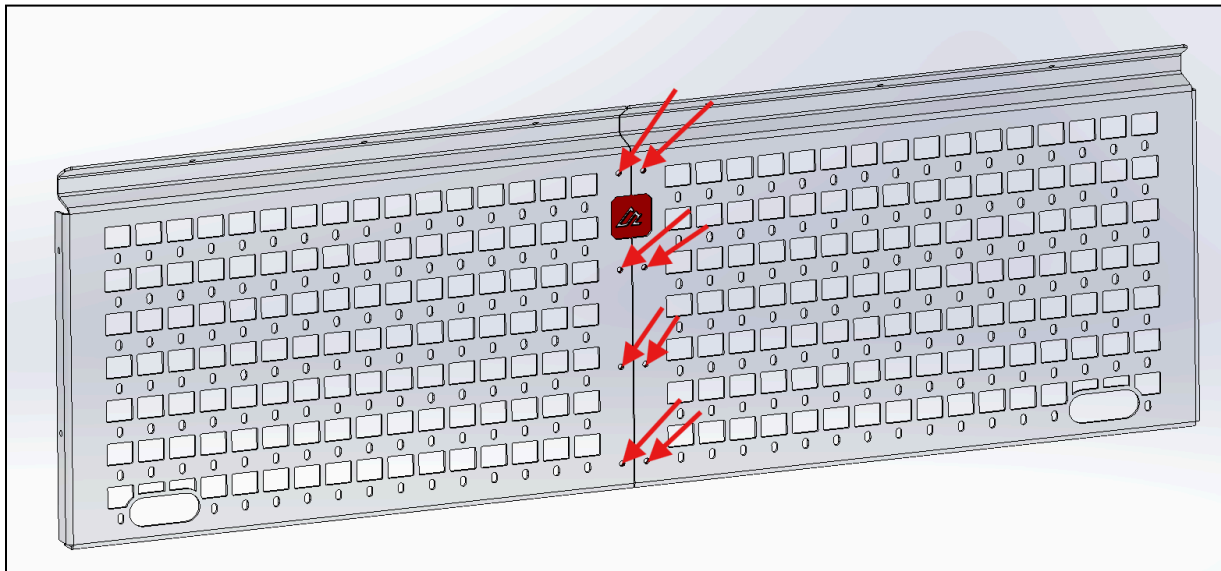

Then bolt the front connector brace to the two panels through the Underside of the panels using **(4) M6x14mm Button Head Bolts** and **(4) M6 Locknuts**

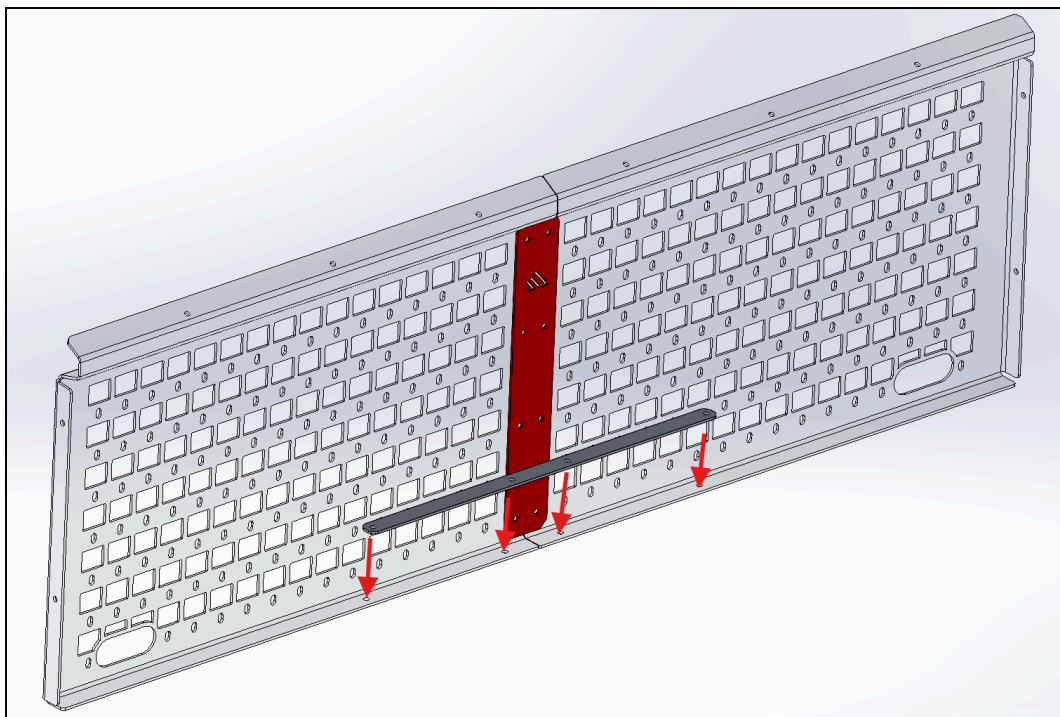

Step 2 - Attach the Mounting Brackets

Align the driver side brace with the two holes on the driver side flange of the front panel and bolt together using **(2) M6x14mm Button Head Bolts** and **(2) M6 Locknuts**

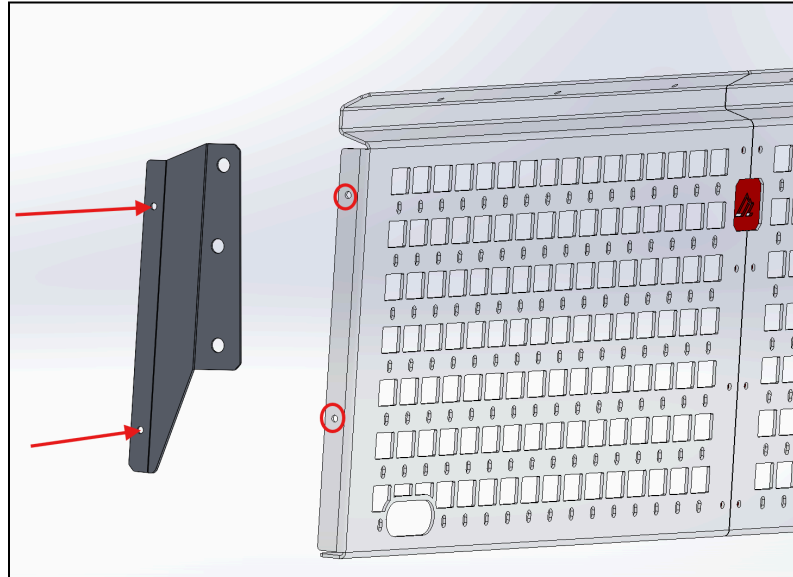

Do the same on the passenger side

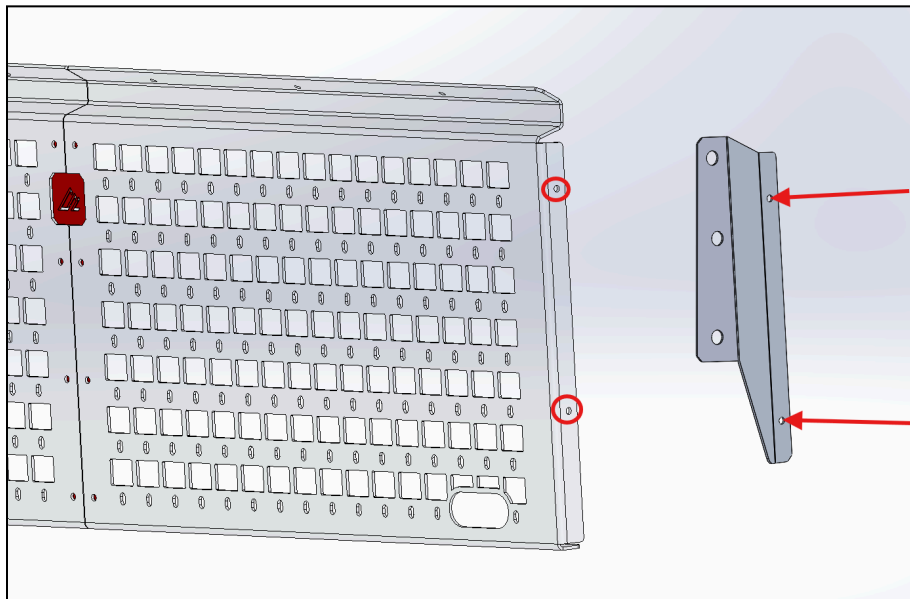

Step 3 - Mount the Front Panels to the Truck Bed

Move the fixture into the bed of the truck and slide it to the front of the bed. Align the 3 holes outlined earlier on the front on both sides. Align them with the mounting brackets on both sides and fasten using the **(2) factory bolts** we removed earlier on the two lowest holes, and an **M8x20mm Button Head Flange Bolt (orange)** on the top hole.

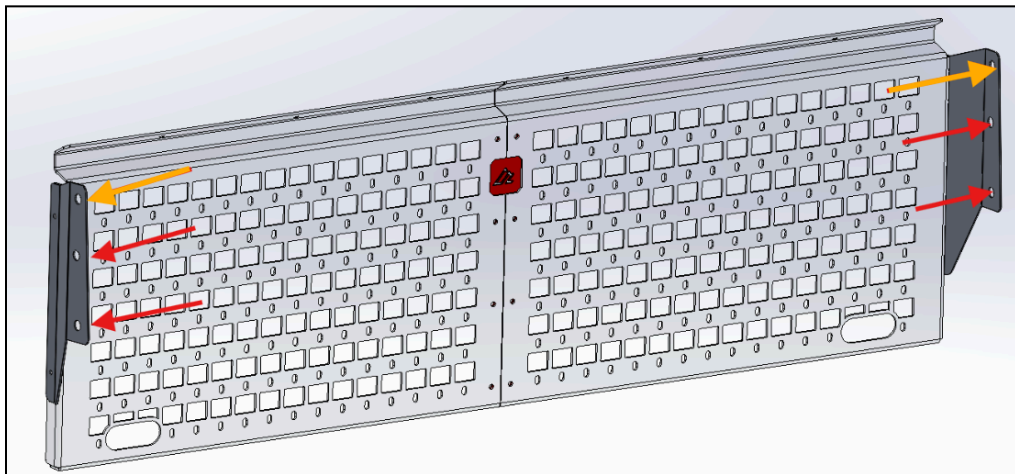
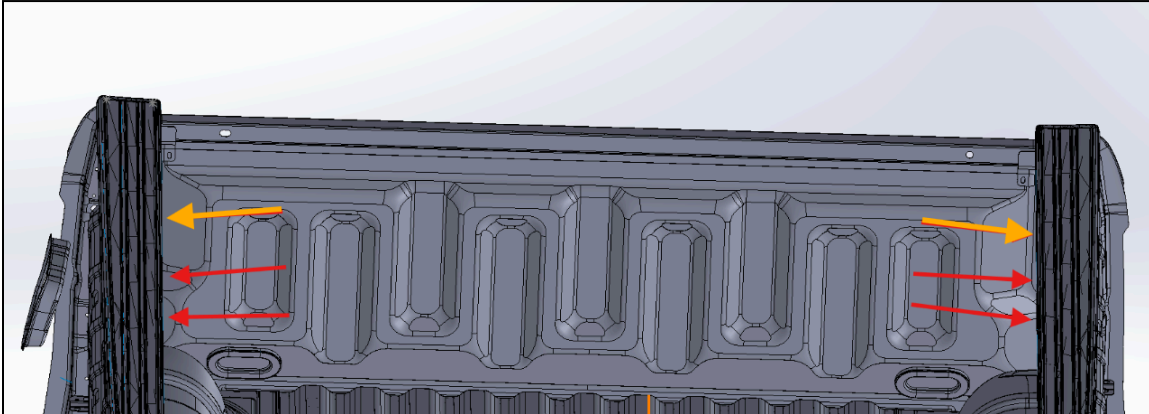

Finally use **(2) M6x14mm Button Head Bolts** to fasten the top edge flange of the front panels to the truck bed

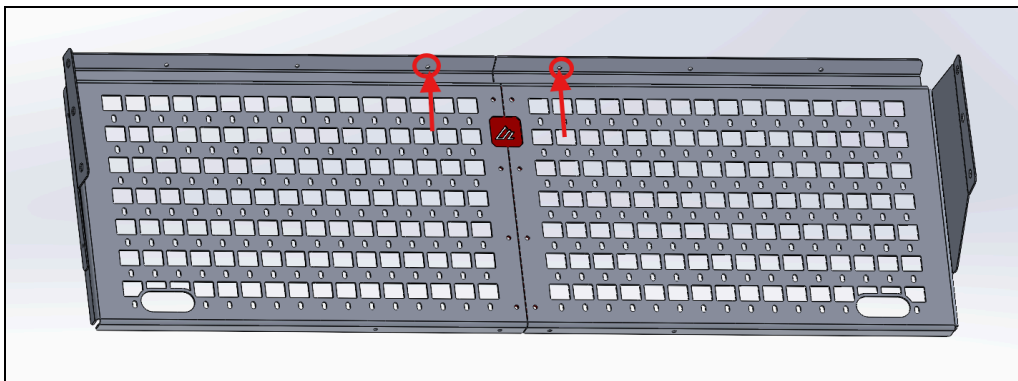

SIDE BED MOLLE ASSEMBLY

If you didn't purchase the Side Bed MOLLE Panels, skip this section. Note that the assembly process is identical for both the driver and passenger side. We'll use the driver side as the example

Step 1 - Connect the Side MOLLE Panels

Flip over the **Front and Rear Side Panels** and align the **Middle Connector** Bracket with the six holes shown below.

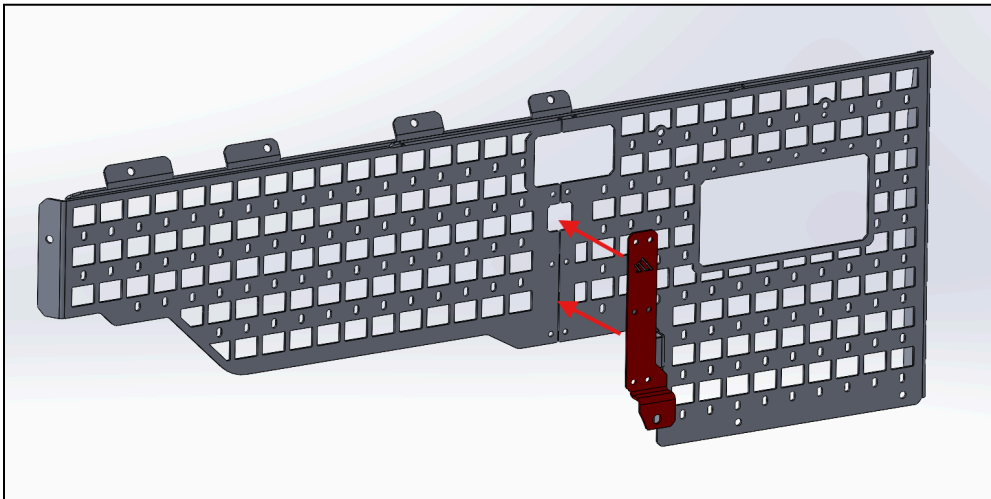

Then using **(6) M6x14mm button head bolts** and **(6) M6 Nuts**, bolt the connector into the front face of the panels

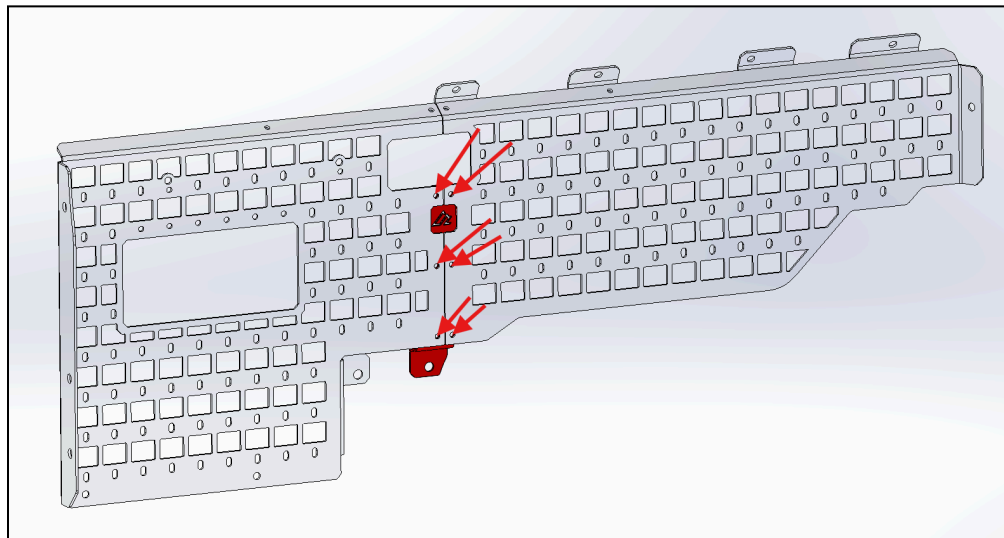

Then using **(4) M6x14mm button head bolts** and **(4) M6 Nuts**, bolt the upper connector to the back of the panel through the front face.

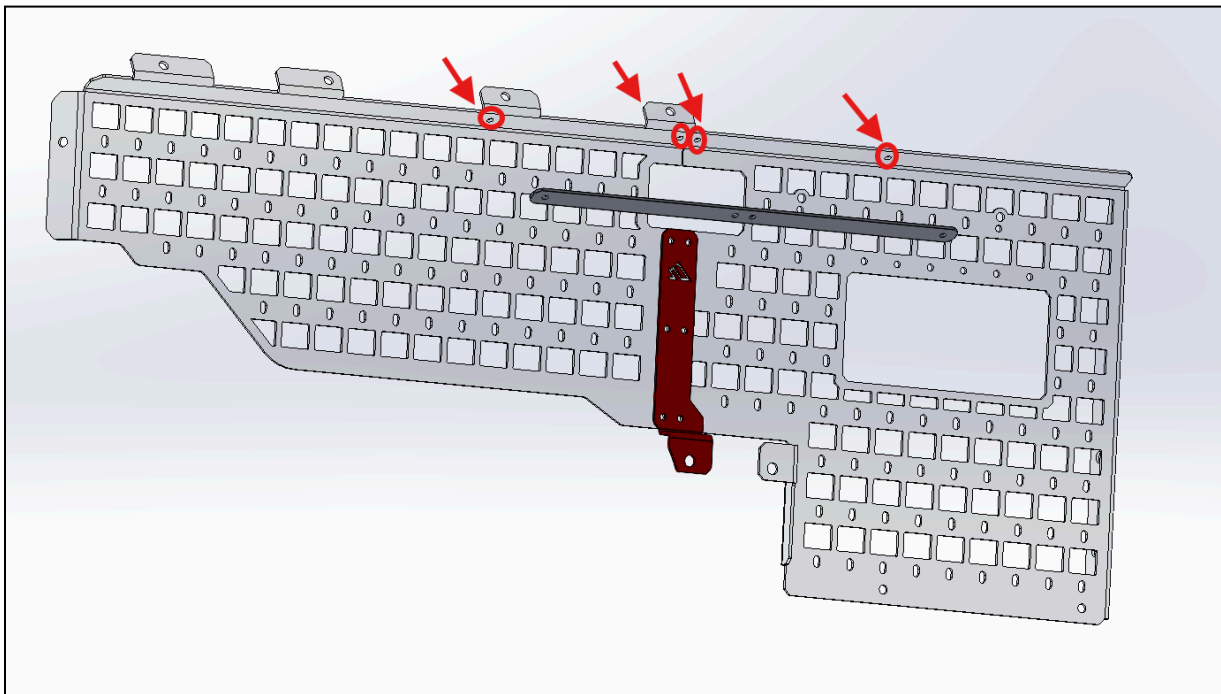

Step 2 - Mount the Panels to the Truck Bed

Move the fixture into the bed of the truck and slide it to the corresponding side of the bed. Align the four front tabs with the holes on the top of the bed edge as well as the holes we created by removing the factory bolts earlier. Fasten these tabs into the bed using **(4) M6x14mm Button Head Flange Bolts (red)** and **(1) M8x20mm Button Head Flange Bolt (orange)**.

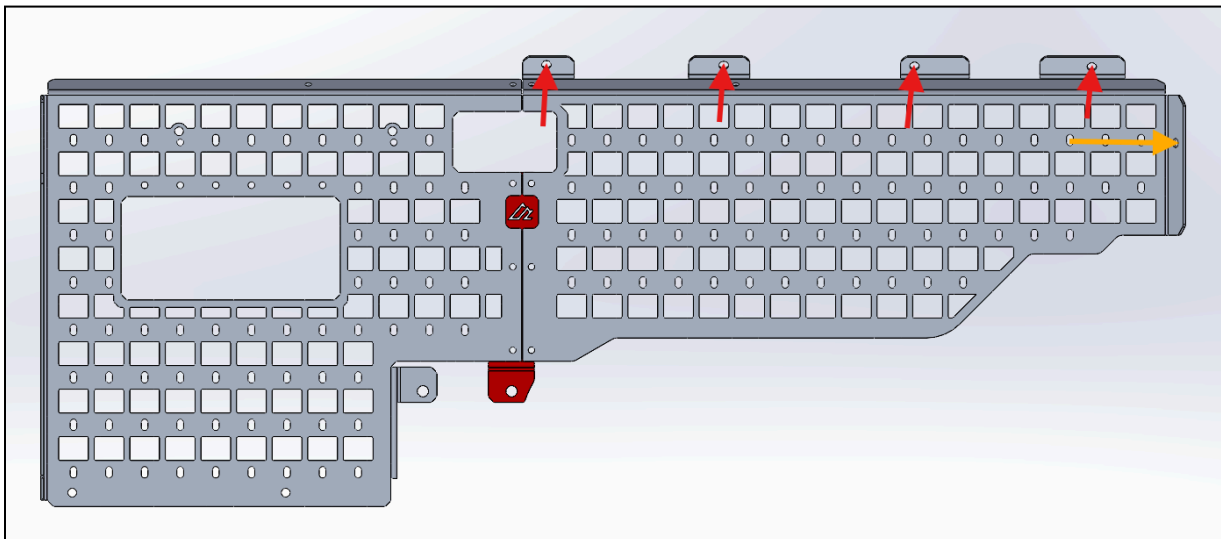

Next using the (4) **Factory Bolts (blue)** and (1) **M8x20mm Button Head Flange Bolt (orange)**, attach the following flanges to the bed

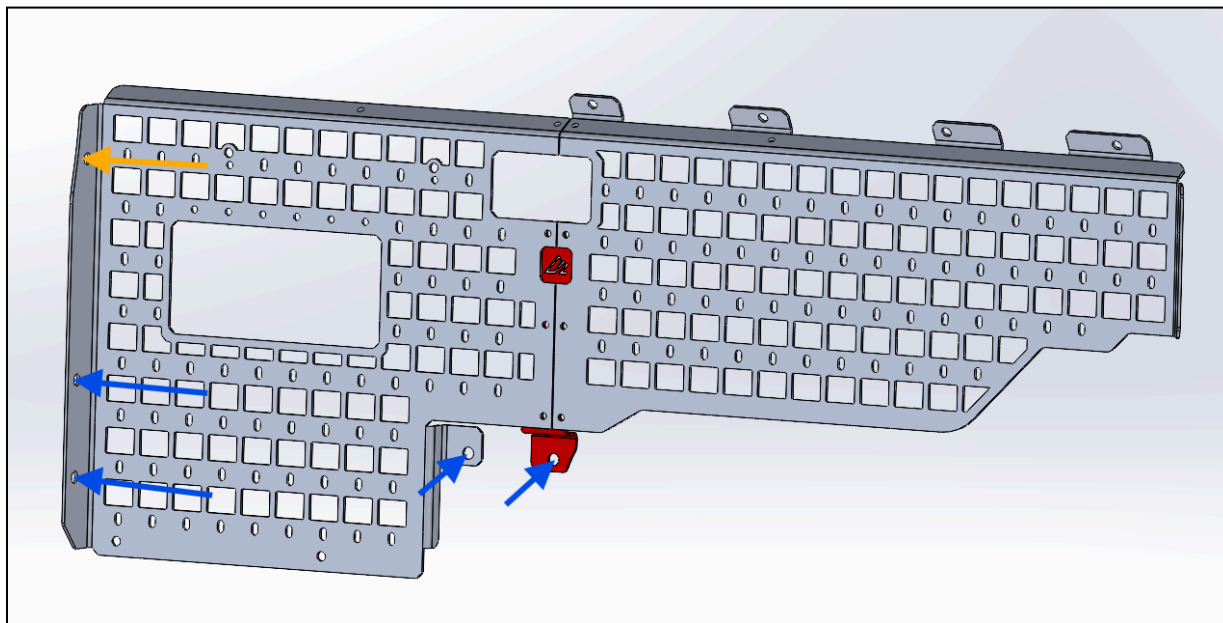

Repeat the exact same process to attach the passenger side!

Share Your Photos!

We take great pride in building our products and we hope that pride extends to you after installing your Bed MOLLE Panels. If you are able to share your photos online (Facebook and Instagram), please tag **@AmericanAdventureLab**. We would love to see how it turned out and give you some reciprocal attention in return!

Congrats! You're all done!

Thank you!

At American Adventure Lab, we strive to improve anywhere we can. If you experience any issues with this product or have any suggestions, please let us know.

If you have any questions or concerns, please don't hesitate to reach out to us at 385.202.4188 or via email at Support@erp.adventurelab.com.

